



**M.M.E. AIR WINCHES
WAP SERIES WINCHES
(2000 to 4500 kg)**

**VERSATILE TUGGER &
UTILITY WINCHES**



RELIABLE FAST EFFICIENT QUIET EASY MOUNTING

LIFTING YOUR WORLD

MME WAP series multi-purpose piston air winches are designed specifically to cope with the harsh conditions encountered in mining, construction and general engineering applications. Tugger winches are solely for pulling applications while utility winches are suitable for lifting and lowering loads. The winches have a factor of safety in excess of 5 at the rated load. They comply with the requirements of ASME B30.7. The manufacturing facility producing the winches is **ISO9001, ISO14001 & OHSAS18001** certified.

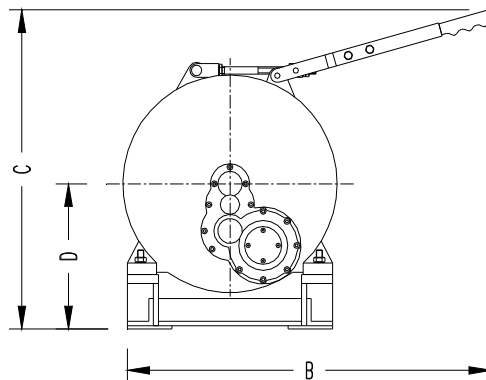
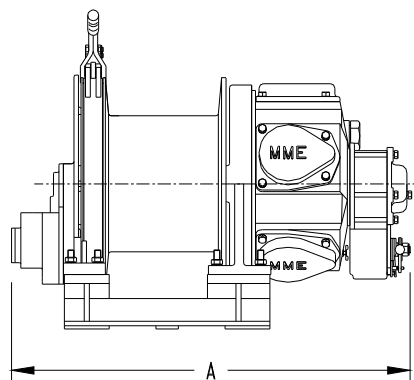

Management System
ISO 9001:2008

www.tuv.com
ID 9105085673

TECHNICAL SPECIFICATIONS @ 6.3 bar (90psi)

Model	WAP2000	WAP2500	WAP3500	WAP4500
Lifting Capacity (tonne)	2.0	2.5	3.5	4.5
Rope Speed at Rated Load (m/min)	30.0	16.0	22.0	16.5
Max Stall Pull on 1 st Layer (kg)	4100	7500	8000	9000
Air Consumption (m ³ /min)	28	23	28	23
Recommended Rope Size (mm) – Hauling *	16	16	16	18
Recommended Rope Size (mm) – Lifting *	16	16	20	20
Max Rope Storage Length (m) – Based on Hauling Rope Ø	100	100	100	80
Weight Without Wire Rope (kg)	190	190	190	190
Air Connection: Toggle Control	1 ½"	1 ½"	1 ½"	1 ½"
Spool Valve Control	1 ¼"	1 ¼"	1 ¼"	1 ¼"
Supply Hose (Inside Ø) (mm)	1 ½"	1 ½"	1 ½"	1 ½"
Dimensions (mm)				
A	950	950	950	950
B	825	825	825	825
C	715	715	715	715
D	320	320	320	320
Drum Length (mm)	250	250	250	250
Drum Diameter (mm)	300	300	300	300

* Refer to local legislation, regulations, standards or procedures

FEATURES AND CHARACTERISTICS

- Precise Control** : Fail safe manual lever control offers variable speed control. Accurate and precise positioning of loads is standard for all models. The valve shuts off automatically when released, thereby stopping the supply of compressed air to the motor and the fail safe brake (if fitted) which is then applied automatically.
- Brake** : Manual brake (Tugger Winches) or optional fail safe brake (Utility Winches) capable of holding in excess of 125% of the working load limit. The non-asbestos brake bands are adjustable to take up friction lining wear. The fail safe brake is applied automatically when the air supply to the winch is shut off.
- Exhaust Silencer** : The non clogging exhaust air silencer limits the noise level to 85dB(A).
- Piston Motor** : Piston air motor ensures maximum starting torque when starting under load.
- Sealed Drive Unit** : The sealed drive motor and gearbox ensures that the most stringent duty cycles can be met. The gears are heat treated and mounted on high strength, low friction bearings.
- Ease of Maintenance** : The modular design of the winch allows easy access to internal components such as the motor, gearbox, brake and drum assembly. Common parts are used throughout the range.

M.M.E. MANUFACTURING CO. (PTY) LTD

P.O. BOX 355 CARLETONVILLE 2500, SOUTH AFRICA

TEL: +27 (18) 788-6674/5/6

Email: info@mmelifting.com

FAX: +27 (18) 786-1479

Website: www.mmelifting.com